

# DATASHEET

Adapter SC/APC Simplex SM one piece, flangeless, green, ceramic sleeve

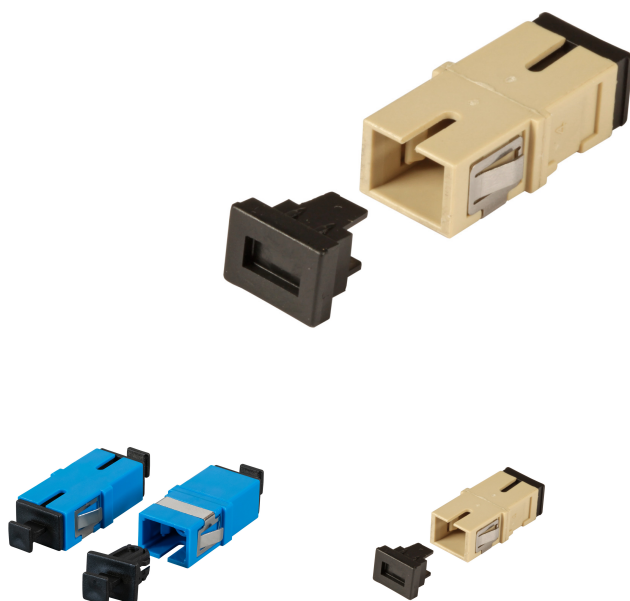

## General data

- Flangeless adapter are good for high density and could be used as keystone modules in consumption with keystone adapter frames

## Allgemeine Daten

Type of housing	flangeless
Insertion loss 850nm	-
Type of fastening	snap-in

## General data

Internal Shutter	False
Height	9.2 mm

## Mechanical characteristics

Material sleeve	ceramic
Construction type	SC-Simplex
Material housing	plastic

This datasheet was created automatically on 15-05-2024 . Technical changes reserved.



# DATASHEET

## Adapter SC/APC Simplex SM one piece, flangeless, green, ceramic sleeve

Dust cover	True
------------	------

### Kabelaufbau

Type of connector connection 1	SC
Type of connector connection 2	SC

### Abmessungen

Width	14.7 mm
Length	27.5 mm

### Umgebungsbedingungen

Operating Temperature	-40 - 85 °C
Storage Temperature	-40 - 85 °C

### Standards, approvals, certifications

Conform to Standard	IEC61754-4
---------------------	------------

### Available variants

ArtNr.	Bezeichnung	Category	Colour	Insertion loss 1310nm	Insertion loss 850nm	Model	Suitable for type of fibre
53513.10M5	Adapter SC Simplex OM5 one piece, flangeless, lime green, ceramic sleeve	OM5	lime green	-	< 0.15 dB	SC / PC	Multi mode
53513.1	Adapter SC Simplex OM4 one piece, flangeless, erica violet, ceramic sleeve	OM4	erica-violet	-	< 0.15 dB	SC / PC	Multi mode
53512.1	Adapter SC Simplex OM3 one piece, flangeless, aqua, ceramic sleeve	OM3	aqua	-	< 0.15 dB	SC / PC	Multi mode
53510.1	Adapter SC Simplex OM1/2 one piece, flangeless, beige, ceramic sleeve	OM2	beige	< 0.15 dB	-	SC / PC	Multi mode
53511.1	Adapter SC Simplex SM one piece, flangeless, blue, ceramic sleeve	OS2	blue	-	< 0.15 dB	SC / PC	Single mode

This datasheet was created automatically on 15-05-2024 . Technical changes reserved.



# DATASHEET

## Adapter SC/APC Simplex SM one piece, flangeless, green, ceramic sleeve

53518.1	Adapter SC/APC Simplex SM one piece, flangeless, green, ceramic sleeve	OS2	green	< 0.15 dB	-	SC / APC Single mode
---------	--	-----	-------	-----------	---	----------------------

### Drawings

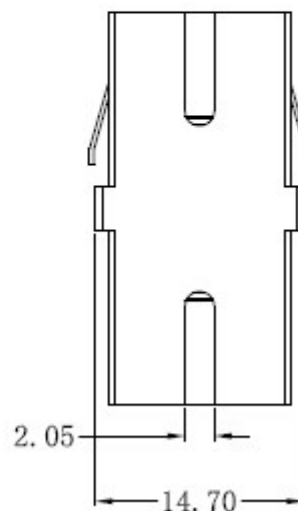
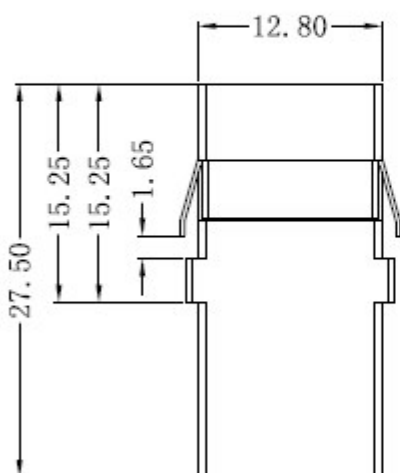
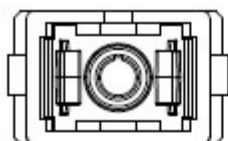

This datasheet was created automatically on 15-05-2024 . Technical changes reserved.

